

Shakespeare Road, Herne Hill, SE24

1 bedroom flat - conversion for sale

£450,000

Share of Freehold

Property Details

This lovely Victorian flat occupies the middle floor of one of the attractive houses in Poets' Corner. Shakespeare Road is a quaint, tree-lined Victorian road sandwiched between similar roads in this sought-after residential pocket, adjacent to Brockwell Park, and equidistant to leafy Herne Hill and vibrant Brixton. The property boasts a wonderfully bright, open plan reception room at the front of the house, flooded with natural light and complete with a brand new finish throughout and plenty of character. There is enough space for both relaxing and dining, whilst high ceilings provide a sense of space. The modern kitchen is tastefully designed and provides all you might need in terms of storage and worktop space. The bedroom is a well-proportioned double room, tucked away quietly at the rear of the property overlooking the neighbouring gardens below. The bathroom is modern, sleek and inviting. This is a beautiful and neutrally presented flat, perfect for anyone looking to move in straight away and stamp their own mark over time.

Features

- One double bedroom
- Bright and airy throughout
- Newly refurbished with tasteful finishes
- Victorian conversion
- Sought-after location
- Local amenities and transport links of Herne Hill
- Share of freehold
- Chain-free

Council tax band EPC rating C (77)



Shakespeare Road, Herne Hill, SE24



1 Bedroom Flat

Approx internal area:

547 sqft 51 sqm

While we do try our very best, floor plans are produced as a guide only and we take no responsibility for the precise accuracy with which any property is represented

Shakespeare Road

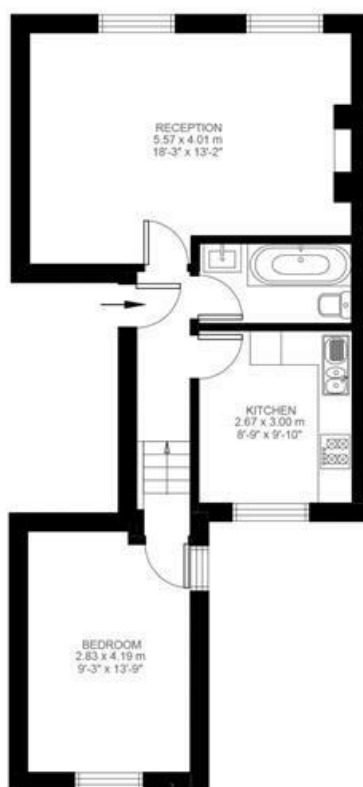

First Floor



Shakespeare Road, Herne Hill, SE24

